

## ALIMENTATORI MODULARI LINEA DOPPIA

### CARATTERISTICHE TECNICHE:

- Pressione d'esercizio in entrata:  
min. 3 MPa, max 40 MPa
- Viscosità olio: min. 15 cSt
- Max densità grasso: 220 ASTM NLGI 3
- Cicli di lavoro: 100 al minuto
- Temperatura di esercizio: -30 +80° C
- Regolazione portata: 0,1-24 cm<sup>3</sup>
- Connessioni: ingresso Rp 3/8 UNI-ISO 7/1 - NPTF,  
uscita Rp 1/4 UNI-ISO 7/1 - NPTF

## DUAL LINE MODULAR FEEDERS

### TECHNICAL CHARACTERISTICS:

- Inlet working pressure:  
min. 3 MPa (435 PSI), max 40 MPa (5800 PSI)
- Oil viscosity: min. 15 cSt
- Max grease viscosity: 220 ASTM NLGI 3
- Working cycles: 100/min.
- Working temperature: -30 +80° C
- Output adjustment: 0,1-24 cm<sup>3</sup>
- Connections: inlet Rp 3/8 UNI-ISO 7/1 - NPTF,  
output Rp 1/4 UNI-ISO 7/1 - NPTF

### DISPOSITIVO PER UNIRE O SEPARARE LE USCITE

Gli alimentatori vengono forniti con uscite separate, qualora la richiesta sia diversa per unire le due uscite in una, bisogna operare come segue:

- 1) Smontare l'alimentatore dalla sottobase;
- 2) Togliere due guarnizioni OR codici 9189174 dal retro dell'alimentatore come indicato dalla figura A;
- 3) Tappare l'uscita non utilizzata dalla sottobase.
- 4) Rimontare l'alimentatore sulla sottobase.

Facendo questa operazione si otterrà che l'uscita erogherà la portata determinata da un doppio spostamento del pistone dosatore.

### DEVICE TO LINK OR SPLIT OUTLETS

Feeders are usually supplied with split outlets. If the application requires only one outlet, then the following must take place:

- 1) Disassemble the feeder to the base;
- 2) Remove two o-rings code 9189174 from the back of the feeder as in figure A;
- 3) Plug unutilized outlet of the base;
- 4) Re-assemble feeder on the base.

As a consequence of the above operations, the remaining outlet will deliver twice the volume of lubricant, since both are now connected to one.

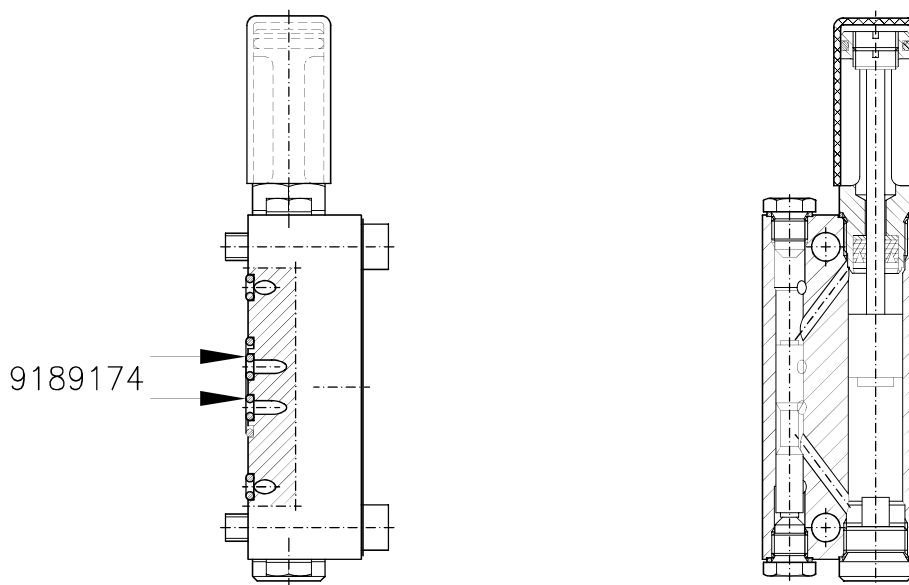
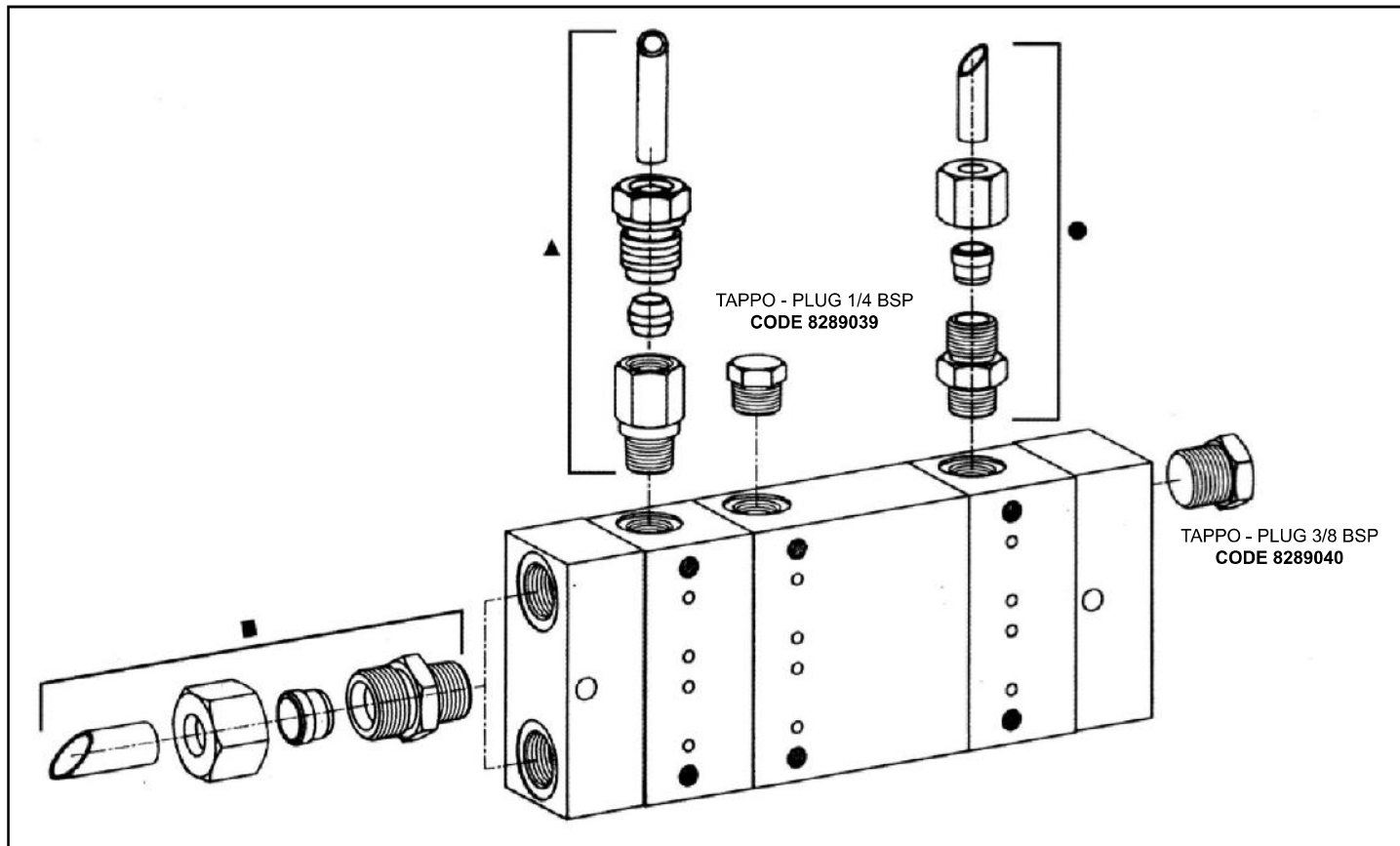

Fig. A



**ALIMENTATORI MODULARI LINEA DOPPIA**

**DUAL LINE MODULAR FEEDERS**



**MATERIALE**

**MATERIAL**

Descrizione Description	Acciaio AVP Carbon Steel		Acciaio Inox Stainless Steel		Portata Output
	Filettatura Thread BSP	Filettatura Thread NPTF	Filettatura Thread BSP	Filettatura Thread NPTF	
Elemento iniziale - Initial base element	8164380	8164395	8164396	8164397	—
Elemento Finale - Final base element	8010002	8010004	8010006	8010008	—
Elemento intermedio - intermediate element DFL 1/3	8010001	8010003	8010005	8010007	—
Elemento intermedio - intermediate element DFL 12/24	8010009	8010010	8010011	8010012	—
Valvola dosatrice - Metering valve DFL3	5010090	5010090	5010094	5010094	0,1 ÷ 3 cm <sup>3</sup>
Valvola dosatrice - Metering valve DFL3F	5010091	5010091	5010095	5010095	3 cm <sup>3</sup>
Valvola dosatrice - Metering valve DFL12	5010092	5010092	5010096	5010063	0,5 ÷ 12 cm <sup>3</sup>
Valvola dosatrice - Metering valve DFL12F	5010093	5010093	5010097	5010097	12 cm <sup>3</sup>
Piastra chiusura - Closing plate	5010099	5010099	5010100	5010100	—
Valvola dosatrice - Metering valve DFL 24	5010172	5010172	—	—	0,5 ÷ 24 cm <sup>3</sup>
Valvola dosatrice - Metering valve DFL 1F	5010098	5010098	—	—	1 cm <sup>3</sup>

● Terminale completo complete terminal PN400	Tubo / Tube Ø 6	Tubo / Tube Ø 8	Tubo / Tube Ø 10
	7104002 1/4 BSP	7104004 1/4 BSP	7104005 1/4 BSP

▲ Terminale completo complete terminal PN150	Tubo / Tube Ø 6	Tubo / Tube Ø 8	Tubo / Tube Ø 10
	7093007 1/4 BSP	7093012 1/4 BSP	7093015 1/4 BSP

■ Terminale completo complete terminal PN400	Tubo / Tube Ø 10	Tubo / Tube Ø 12	Tubo / Tube Ø 16
	7104002 3/8	7104024 3/8	7104025 3/8 BSP



**TABELLA CODICI ALIMENTATORI  
MONOBLOCCO A DOPPIA LINEA**
**DUAL LINE FEEDERS  
ENBLOC CODES TABLE**

Tipo alimentatore <i>Feeders</i>	Portata <i>Output</i>	N. uscite <i>Number of outlets</i>	Cod. con filett. BSP <i>Code with BSP thread</i>	Cod. con filett. NPTF <i>Code with NPTF thread</i>	Pag. rif. <i>Ref. Page</i>
DP/1	0,1-0,5 cm <sup>3</sup>	2	5010014	5010045	8
DP/2	Regolabile	4	5010015	5010046	
DP/3	<i>Adjustable</i>	6	5010016	5010047	
DP/4		8	5010017	5010048	
DP1/1	0,1-1 cm <sup>3</sup>	2	5010024	5010074	8
DP1/2	Regolabile	4	5010025	5010075	
DP1/3	<i>Adjustable</i>	6	5010026	5010076	
DP1/4		8	5010027	5010077	
DP6/1	0,25-1,5 cm <sup>3</sup>	2	5010001	5010051	9
DP6/2	Regolabile	4	5010002	5010052	
DP6/3	<i>Adjustable</i>	6	5010003	5010053	
DP6/4		8	5010004	5010054	
DG6/1	0,25-3 cm <sup>3</sup>	2	5010010	5010040	9
DG6/2	Regolabile	4	5010011	5010041	
DG6/3	<i>Adjustable</i>	6	5010012	5010042	
DG6/4		8	5010013	5010043	
DGG6/1	1,5-12 cm <sup>3</sup>	2	5010019	5010084	10
DGG6/2	Regolabile	4	5010020	5010085	
DGG6/3	<i>Adjustable</i>	6	5010021	5010086	
DGG6/4		8	5010022	5010087	
DP/05F	0,5 cm <sup>3</sup>	2	5010114	5010129	11
DP/05F	Fissa	4	5010115	5010130	
DP/05F	<i>Fix</i>	6	5010116	5010131	
DP/05F		8	5010117	5010132	
DP1/1F	1 cm <sup>3</sup>	2	5010124	5010134	11
DP1/2F	Fissa	4	5010125	5010135	
DP1/3F	<i>Fix</i>	6	5010126	5010136	
DP1/4F		8	5010127	5010137	
DP6/1F	1,5 cm <sup>3</sup>	2	5010101	5010070	12
DP6/2F	Fissa	4	5010102	5010071	
DP6/3F	<i>Fix</i>	6	5010103	5010072	
DP6/4F		8	5010104	5010073	
DG6/1F	3 cm <sup>3</sup>	2	5010110	5010080	12
DG6/2F	Fissa	4	5010111	5010081	
DG6/3F	<i>Fix</i>	6	5010112	5010082	
DG6/4F		8	5010113	5010083	
DGG6/1F	1,2 cm <sup>3</sup>	2	5010119	5010139	12
DGG6/2F	Fissa	4	5010120	5010140	
DGG6/3F	<i>Fix</i>	6	5010121	5010141	
DGG6/4F		8	5010122	5010142	



**ALIMENTATORI DOPPIA LINEA  
MONOBLOCCO PORTATA REGOLABILE**

**DUAL LINE FEEDERS  
ENBLOC ADJUSTABLE OUTPUT**

**TIPO DP - portata 0,1 cm<sup>3</sup> ÷ 0,5 cm<sup>3</sup>**

**DP series - output 0,1 cm<sup>3</sup> ÷ 0,5 cm<sup>3</sup>**

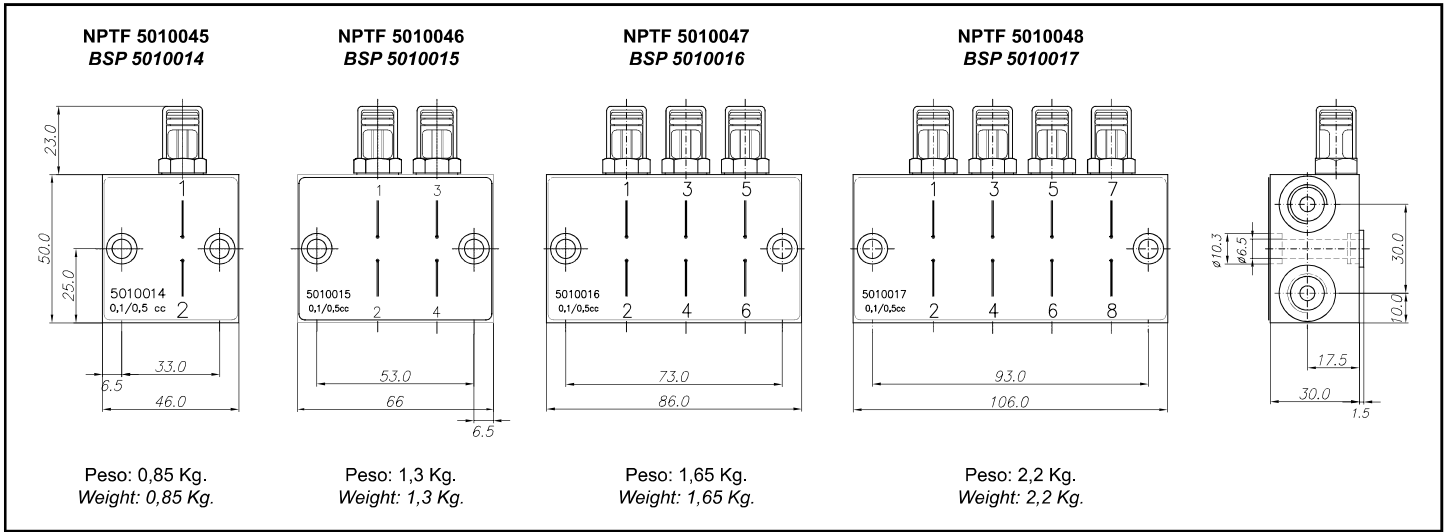

**TIPO DP1 - portata 0,1 cm<sup>3</sup> ÷ 1 cm<sup>3</sup>**

**DP1 series - output 0,1 cm<sup>3</sup> ÷ 1 cm<sup>3</sup>**

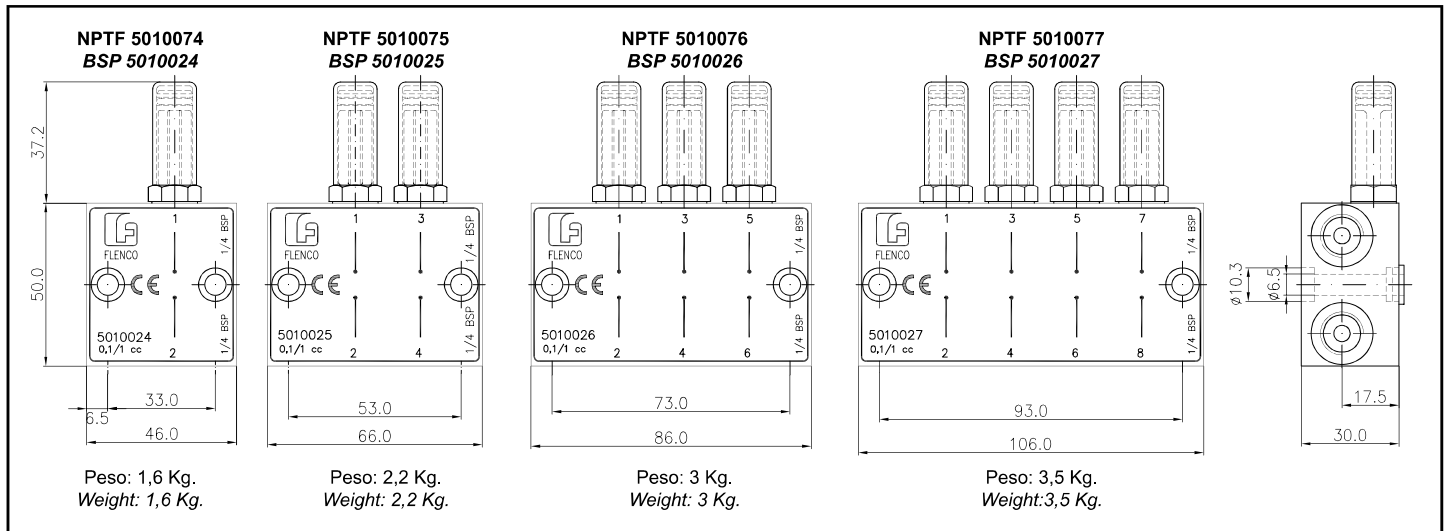

**GIUNZIONE A PONTE  
PER VALVOLE SERIE DP-DP1**

**Codice 7310002**  
unisce le uscite  
dello stesso elemento

Peso: 25 gr

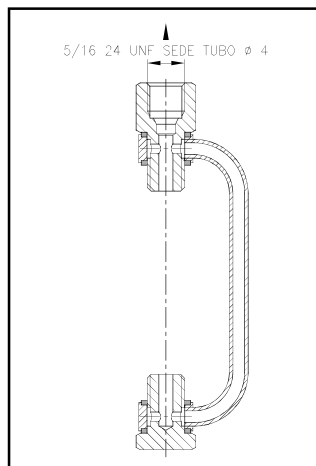

**BRIDGE JOINT  
FOR DP-DP1 SERIES BLOCKS**

**Code 7310002**  
for the outlets  
of the same element

Weight: 25 gr.



**ALIMENTATORI DOPPIA LINEA  
MONOBLOCCO PORTATA REGOLABILE**

**DUAL LINE FEEDERS  
ENBLOC ADJUSTABLE OUTPUT**

**TIPO DP6 - portata 0,25 cm<sup>3</sup> ÷ 1,5 cm<sup>3</sup>**

**DP6 series - output 0,25 cm<sup>3</sup> ÷ 1,5 cm<sup>3</sup>**

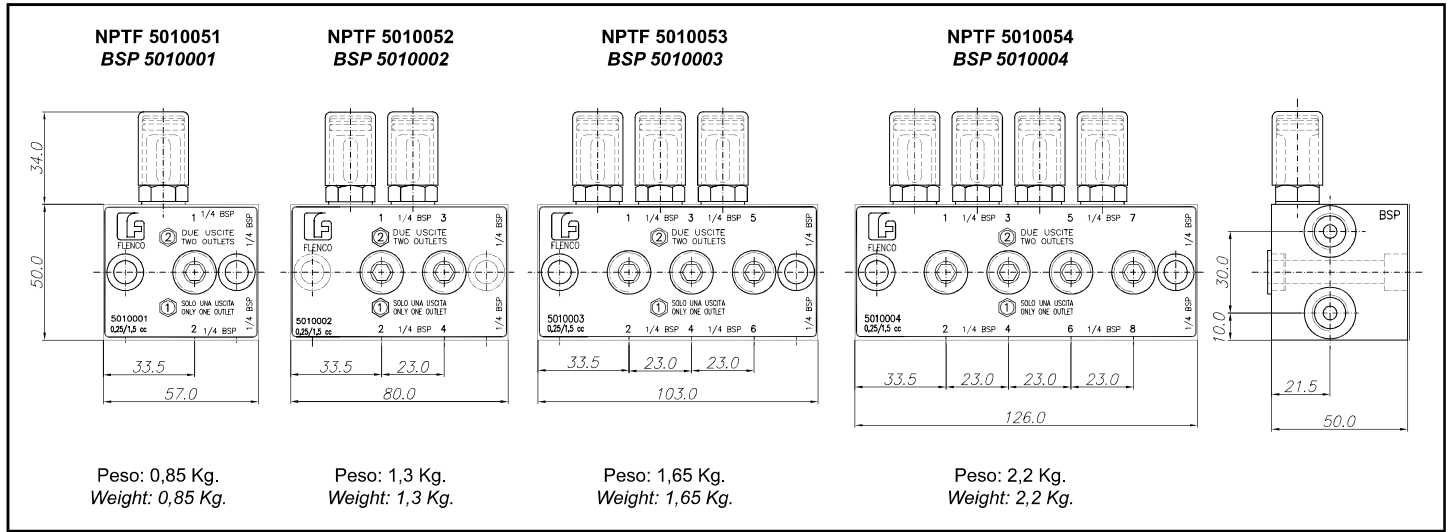

**TIPO DG6 - portata 0,25 cm<sup>3</sup> ÷ 3 cm<sup>3</sup>**

**DP6 series - output 0,25 cm<sup>3</sup> ÷ 3 cm<sup>3</sup>**

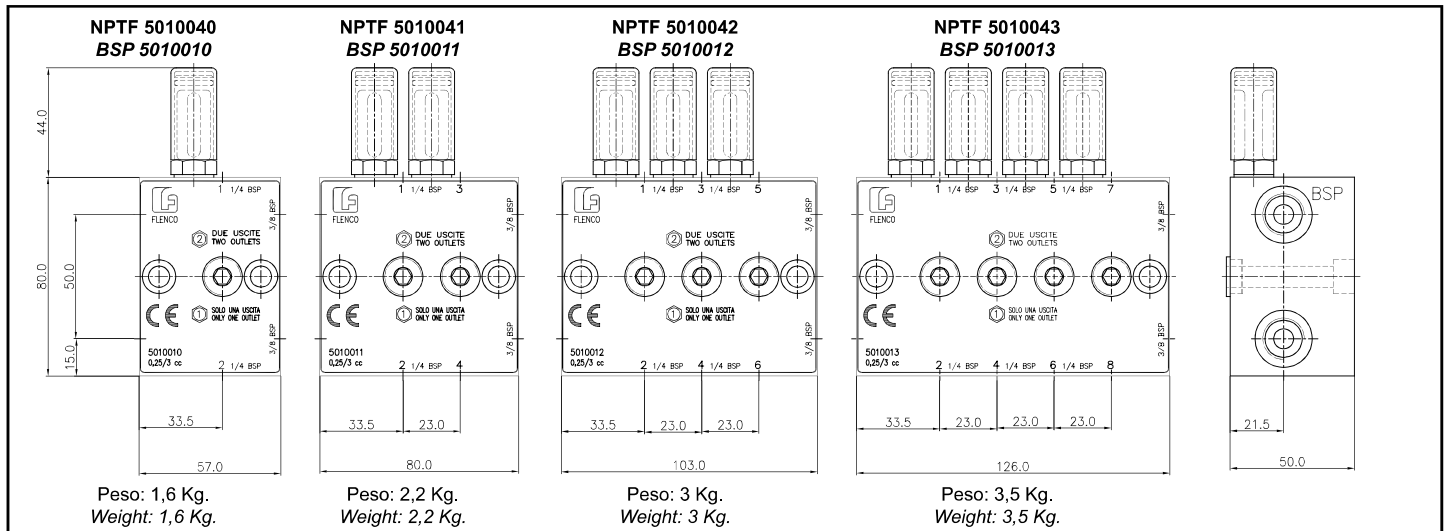



**ALIMENTATORI DOPPIA LINEA  
MONOBLOCCO PORTATA REGOLABILE**

**DUAL LINE FEEDERS  
ENBLOC ADJUSTABLE OUTPUT**

TIPO DGG6 - portata 1,5 cm<sup>3</sup> ÷ 12 cm<sup>3</sup>

DGG6 series - output 1,5 cm<sup>3</sup> ÷ 12 cm<sup>3</sup>

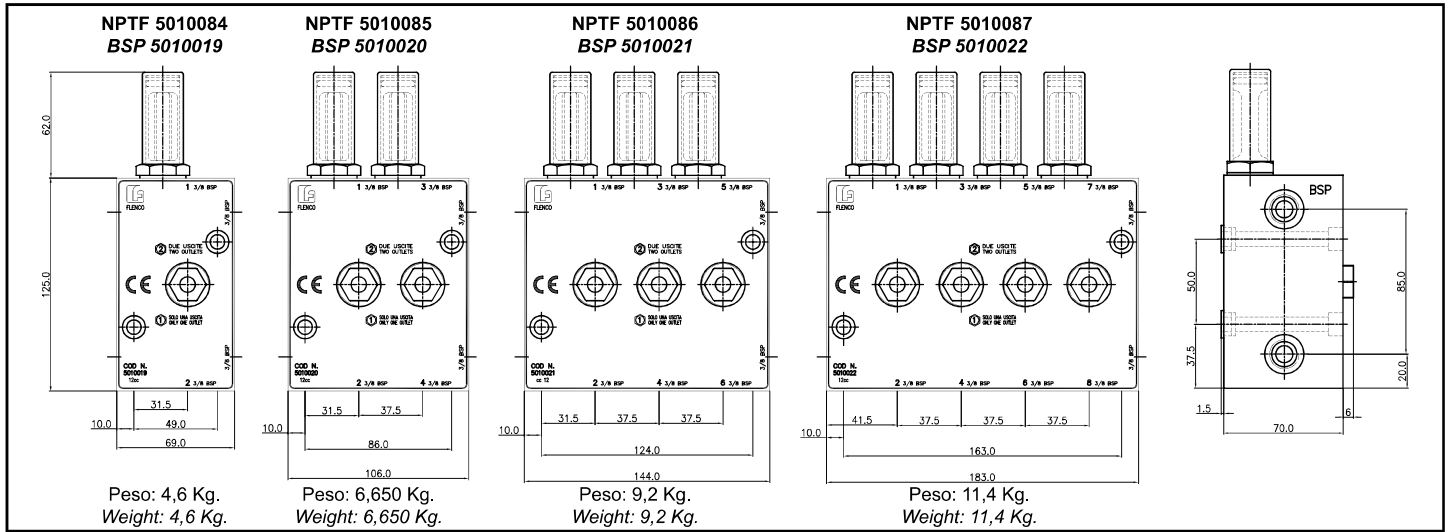

SPECIALE PER MERCATO USA (DD52-54-56-58)  
TIPO DD5 - portata 0,18 cm<sup>3</sup> ÷ 4 cm<sup>3</sup>

SPECIALFORUSAMARKET  
DD5 series - output 0,18 cm<sup>3</sup> ÷ 4 cm<sup>3</sup>

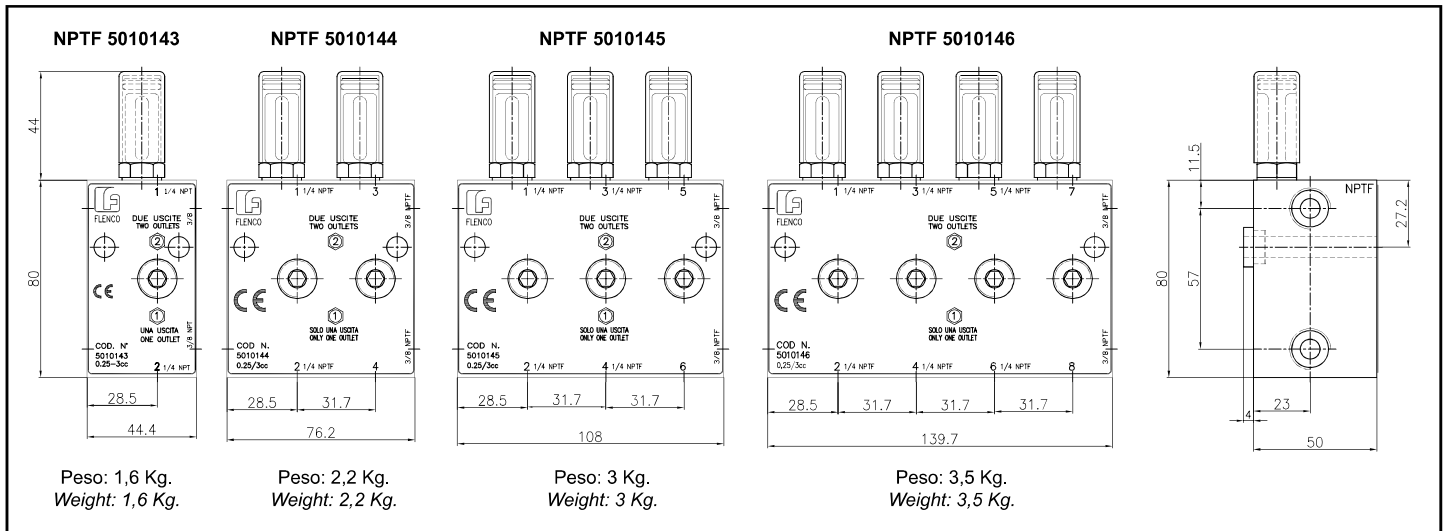

	<b>Tappo bianco White plug</b>	0,18 ÷ 3 cm <sup>3</sup>	8186003
	<b>Tappo nero Black plug</b>	1,25 ÷ 4 cm <sup>3</sup>	8186031

	<b>Cappuccio Cap</b>	Tipo DP	Tipo DPI	Tipo DP6	Tipo DG6/ DD	Tipo DGG6
		8141016	8141018	8141010	8141001	8141020



**ALIMENTATORI DOPPIA LINEA  
MONOBLOCCO PORTATA FISSA**

**DUAL LINE FEEDERS  
ENBLOC FIX OUTPUT**

TIPO DP05/F - portata 0,5 cm<sup>3</sup>

DP05/F series - output 0,5 cm<sup>3</sup>

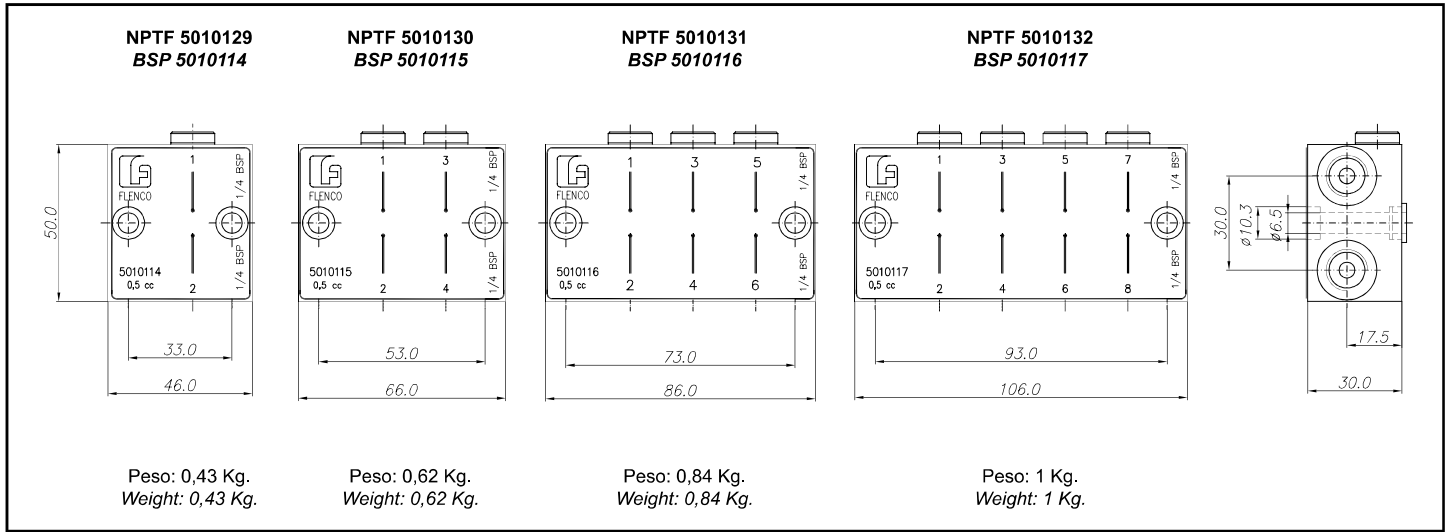

TIPO DP1/F - portata 1 cm<sup>3</sup>

DP1/F series - output 1 cm<sup>3</sup>

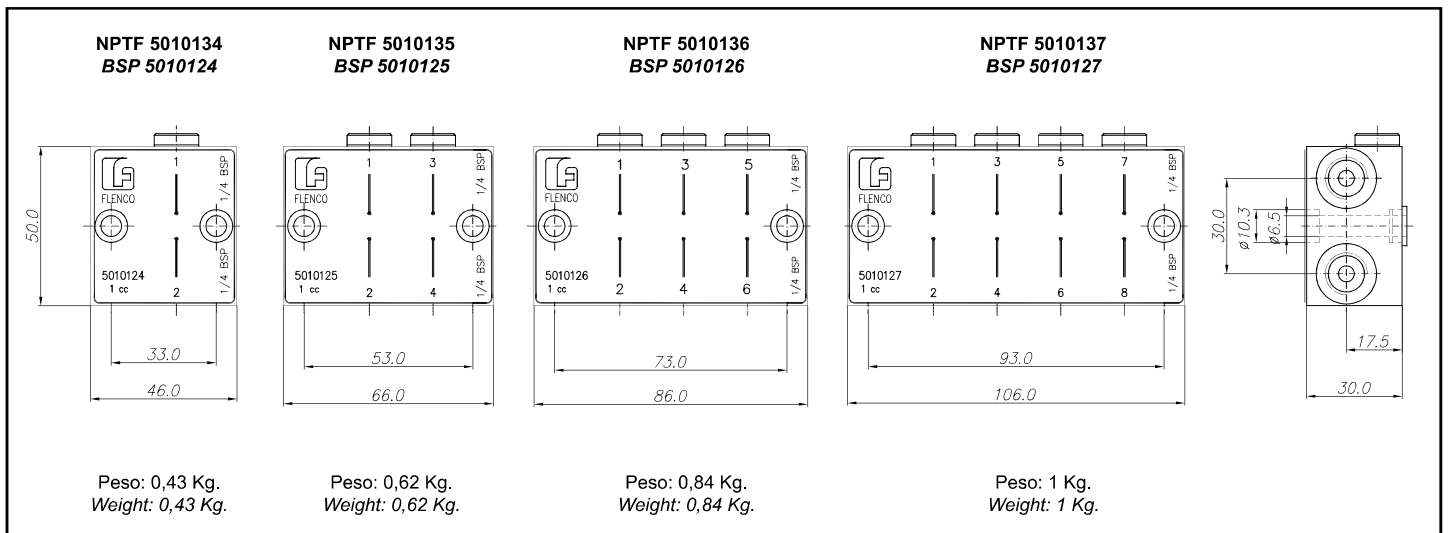



**ALIMENTATORI DOPPIA LINEA  
MONOBLOCCO PORTATA FISSA**

**DUAL LINE FEEDER  
ENBLOC FIX OUTPUT**

**TIPO DP6/F - portata 1,5 cm<sup>3</sup>**

**DP6/F series - output 1,5 cm<sup>3</sup>**

<p><b>NPTF 5010070 BSP 5010101</b></p> <p>Peso: 0,82 Kg. Weight: 0,82 Kg.</p>	<p><b>NPTF 5010071 BSP 5010102</b></p> <p>Peso: 1,23 Kg. Weight: 1,23 Kg.</p>	<p><b>NPTF 5010072 BSP 5010103</b></p> <p>Peso: 1,56 Kg. Weight: 1,56 Kg.</p>	<p><b>NPTF 5010073 BSP 5010104</b></p> <p>Peso: 1,92 Kg. Weight: 1,92 Kg.</p>	
---	---	---	---	--

**TIPO DG6/F - portata 3 cm<sup>3</sup>**

**DP6/F series - output 3 cm<sup>3</sup>**

<p><b>NPTF 5010080 BSP 5010110</b></p> <p>Peso: 1,56 Kg. Weight: 1,56 Kg.</p>	<p><b>NPTF 5010181 BSP 5010111</b></p> <p>Peso: 2,16 Kg. Weight: 2,16 Kg.</p>	<p><b>NPTF 5010082 BSP 5010112</b></p> <p>Peso: 2,82 Kg. Weight: 2,82 Kg.</p>	<p><b>NPTF 5010083 BSP 5010113</b></p> <p>Peso: 3,37 Kg. Weight: 3,37 Kg.</p>	
---	---	---	---	--

**TIPO DGG6/F - portata 12 cm<sup>3</sup>**

**DGG6/F series - output 12 cm<sup>3</sup>**

<p><b>NPTF 5010139 BSP 5010119</b></p> <p>Peso: 4,5 Kg. Weight: 4,5 Kg.</p>	<p><b>NPTF 5010140 BSP 5010120</b></p> <p>Peso: 6,45 Kg. Weight: 6,45 Kg.</p>	<p><b>NPTF 5010141 BSP 5010121</b></p> <p>Peso: 8,9 Kg. Weight: 8,9 Kg.</p>	<p><b>NPTF 5010142 BSP 5010122</b></p> <p>Peso: 11 Kg. Weight: 11 Kg.</p>	
---	---	---	---	--

