



CLOSED AUTOMATIC HOSE REELS

These closed automatic hose reels with spring, fixed or swivelling , in plastic, powder coated , stainless steel AISI 304 are suitable for flexible hoses for the delivery of compressed air, water, oil and similar, grease, diesel, antifreeze liquid, windscreen liquid.

The spring hose allows to untwist only the necessary length, improving the working and functionality.

The hose winding is fast and safe and it allows a work place which give the possibility to work in a free and tidy way, you have always a ready equipment giving to all staffs the warranty to work in a safety way.



**CLOSED HOSE REELS IN PLASTIC SWIVELLING
FOR AIR-WATER 10 bar**

Equipped with:

- Polyurethane blue hoses
- Nickel-plated brass connections
- Swivelling joint 90° nickel-plated brass
- Viton seals

Article	Hose length	Ø hose	Inlet-outlet
075-3401-112	12+1 m	6x10	F1/4" G - M1/4" G
075-3401-209	9+1 m	8x12	F1/4" G - M1/4" G

CS-275



CS-275	3,400	0,018	1

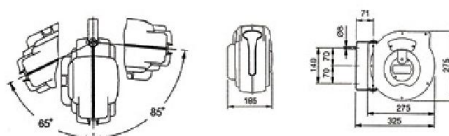

**CLOSED HOSE REELS VARNISHED FIXED
FOR AIR-WATER 20 bar**

Equipped with:

- Polyurethane blue hoses
- Nickel-plated brass connections
- Swivelling joint 90° nickel-plated brass
- Viton seals

Article	Hose length	Ø hose	Inlet-outlet
074-4301-211	11+1,5 m	8x12	F1/4" G - M1/4" G gir.

CF-300



CF-300	11,700	0,026	1

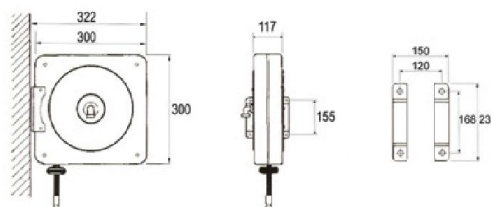

**CLOSED HOSE REELS VARNISHED SWIVELLING
FOR AIR-WATER 20 bar**

Equipped with:

- Polyurethane blue hoses
- Nickel-plated brass connections
- Swivelling joint 90° nickel-plated brass
- Viton seals

Article	Hose length	Ø hose	Inlet-outlet
075-4301-211	11+1,5 m	8x12	F1/4" G - M1/4" G gir.

CS-300



CS-300	12,440	0,026	1

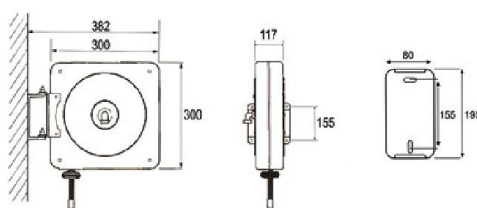

FOR AIR-WATER 20 bar

Equipped with:

- Synthetic black rubber hoses R6
- Galvanized connections
- Swivelling joint 90° nickel-plated brass
- Viton seals



CF-500

Article	Hose length	Ø hose	Inlet-outlet
074-4502-300	Without hose	-	F3/8"G - M3/8"G
074-4502-400	Without hose	-	M1/2"G - M1/2"G
074-4502-212	12 m	5/16"	F3/8"G - M1/4"G
074-4502-218	18 m	5/16"	F3/8"G - M1/4"G
074-4502-310	10 m	3/8"	F3/8"G - M3/8"G
074-4502-318	18 m	3/8"	F3/8"G - M3/8"G
074-4502-410	10 m	1/2"	M1/2"G - M1/2"G
074-4502-415	15 m	1/2"	M1/2"G - M1/2"G
074-4502-418	18 m	1/2"	M1/2"G - M1/2"G

FOR WATER 150° C 200 bar

Equipped with:

- Synthetic rubber hoses no trace blue 1SC
- Galvanized connections
- Swivelling joint 90° stainless steel AISI 304
- Viton seals



CF-500

Article	Hose length	Ø hose	Inlet-outlet
074-4505-300	Without hose	-	M3/8"G - M3/8"G
074-4504-210	10 m	5/16"	M3/8"G - M3/8"G
074-4504-215	15 m	5/16"	M3/8"G - M3/8"G
074-4504-310	10 m	3/8"	M3/8"G - F3/8"G
074-4504-315	15 m	3/8"	M3/8"G - F3/8"G
074-4504-318	18 m	3/8"	M3/8"G - F3/8"G

FOR WATER 150° C 400 bar

Equipped with:

- Synthetic rubber hoses no trace blue 2SC
- Galvanized connections
- Swivelling joint 90° stainless steel AISI 304
- Viton seals



CF-500

Article	Hose length	Ø hose	Inlet-outlet
074-4505-300	Without hose	-	M3/8"G - M3/8"G
074-4505-310	10 m	3/8"	M3/8"G - F3/8"G
074-4505-315	15 m	3/8"	M3/8"G - F3/8"G
074-4505-318	18 m	3/8"	M3/8"G - F3/8"G

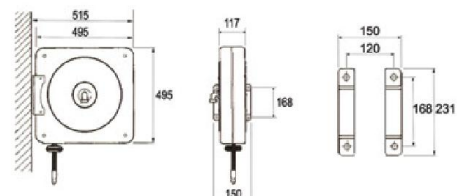

CF-500 22,900x29,850 0,060 1

FOR AIR-WATER 20 bar

Equipped with:

- Synthetic black rubber hoses R6
- Galvanized connections
- Swivelling joint 90° nickel-plated brass
- Viton seals

Article	Hose length	Ø hose	Inlet-outlet
075-4502-300	Without hose	-	F3/8"G - M3/8"G
075-4502-400	Without hose	-	M1/2"G - M1/2"G
075-4502-212	12 m	5/16"	F3/8"G - M1/4"G
075-4502-218	18 m	5/16"	F3/8"G - M1/4"G
075-4502-310	10 m	3/8"	F3/8"G - M3/8"G
075-4502-318	18 m	3/8"	F3/8"G - M3/8"G
075-4502-410	10 m	1/2"	M1/2"G - M1/2"G
075-4502-415	15 m	1/2"	M1/2"G - M1/2"G
075-4502-418	18 m	1/2"	M1/2"G - M1/2"G

CS-500



FOR WATER 150° C 200 bar

Equipped with:

- Synthetic rubber hoses no trace blue 1SC
- Galvanized connections
- Swivelling joint 90° stainless steel AISI 304
- Viton seals

Article	Hose length	Ø hose	Inlet-outlet
075-4505-300	Without hose	-	M3/8"G - M3/8"G
075-4504-210	10 m	5/16"	M3/8"G - M3/8"G
075-4504-215	15 m	5/16"	M3/8"G - M3/8"G
075-4504-310	10 m	3/8"	M3/8"G - F3/8"G
075-4504-315	15 m	3/8"	M3/8"G - F3/8"G
075-4504-318	18 m	3/8"	M3/8"G - F3/8"G

CS-500



FOR WATER 150° C 400 bar

Equipped with:

- Synthetic rubber hoses no trace blue 2SC
- Galvanized connections
- Swivelling joint 90° stainless steel AISI 304
- Viton seals

Article	Hose length	Ø hose	Inlet-outlet
075-4505-300	Without hose	-	M3/8"G - M3/8"G
075-4505-310	10 m	3/8"	M3/8"G - F3/8"G
075-4505-315	15 m	3/8"	M3/8"G - F3/8"G
075-4505-318	18 m	3/8"	M3/8"G - F3/8"G

CS-500

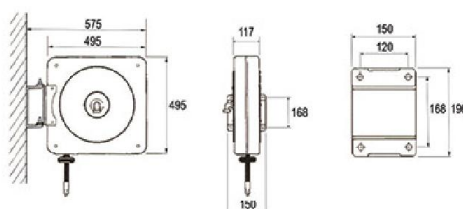

CS-500 23,600x30,550 0,060 1

FOR OIL 160 bar

Equipped with:

- Synthetic black rubber hoses 1SC
- Galvanized connections
- Swivelling joint 90° galvanized
- Polyurethane seals



CF-500

Article	Hose length	Ø hose	Inlet-outlet
074-4506-400	Without hose	-	M1/2"G - M1/2"G
074-4506-410	10 m	1/2"	M1/2"G - M1/2"G
074-4506-415	15 m	1/2"	M1/2"G - M1/2"G
074-4506-418	18 m	1/2"	M1/2"G - M1/2"G

FOR GREASE 600 bar

Equipped with:

- Synthetic black rubber hoses 2SC
- Galvanized connections
- Swivelling joint 90° galvanized
- Polyurethane seals



CF-500

Article	Hose length	Ø hose	Inlet-outlet
074-4507-200	Without hose	-	M1/4"G - M1/4"G
074-4507-300	Without hose	-	M3/8"G - M3/8"G
074-4507-110	10 m	1/4"	M1/4"G - M1/4"G
074-4507-115	15 m	1/4"	M1/4"G - M1/4"G
074-4507-118	18 m	1/4"	M1/4"G - M1/4"G
074-4507-310	10 m	3/8"	M3/8"G - M3/8"G
074-4507-315	15 m	3/8"	M3/8"G - M3/8"G

FOR ANTIFREEZE AND WINDSCREEN 20 bar

Equipped with:

- Antistatic black rubber hoses EPDM
- Stainless steel connections AISI 316
- Stainless steel swivelling joint 90° AISI 316
- Viton seals



CF-500

Article	Hose length	Ø hose	Inlet-outlet
074-4509-400	Without hose	-	M1/2"G - M1/2"G
074-4509-410	10 m	1/2"	M1/2"G - M1/2"G
074-4509-415	15 m	1/2"	M1/2"G - M1/2"G



CF-500 22,900-29,850 0,060 1

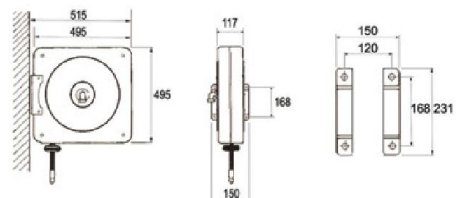

FOR OIL 160 bar

Equipped with:

- Synthetic black rubber hoses 1SC
- Galvanized connections
- Swivelling joint 90° galvanized
- Polyurethane seals

Article	Hose length	Ø hose	Inlet-outlet
075-4506-400	Without hose	-	M1/2" G - M1/2" G
075-4506-410	10 m	1/2"	M1/2" G - M1/2" G
075-4506-415	15 m	1/2"	M1/2" G - M1/2" G
075-4506-418	18 m	1/2"	M1/2" G - M1/2" G

CS-500



FOR GREASE 600 bar

Equipped with:

- Synthetic black rubber hoses 2SC
- Galvanized connections
- Swivelling joint 90° galvanized
- Polyurethane seals

Article	Hose length	Ø hose	Inlet-outlet
075-4507-200	Without hose	-	M1/4" G - M1/4" G
075-4507-300	Without hose	-	M3/8" G - M3/8" G
075-4507-110	10 m	1/4"	M1/4" G - M1/4" G
075-4507-115	15 m	1/4"	M1/4" G - M1/4" G
075-4507-118	18 m	1/4"	M1/4" G - M1/4" G
075-4507-310	10 m	3/8"	M3/8" G - M3/8" G
075-4507-315	15 m	3/8"	M3/8" G - M3/8" G

CS-500



FOR ANTFREEZE AND WINDSCREEN 20 bar

Equipped with:

- Antistatic black rubber hoses EPDM
- Stainless steel connections AISI 316
- Stainless steel swivelling joint 90° AISI 316
- Viton seals

Article	Hose length	Ø hose	Inlet-outlet
075-4509-400	Without hose	-	M1/2" G - M1/2" G
075-4509-410	10 m	1/2"	M1/2" G - M1/2" G
075-4509-415	15 m	1/2"	M1/2" G - M1/2" G

CS-500

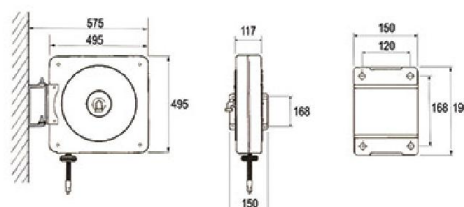

CS-500 23,600<30,550 0,060 1

FOR AIR-WATER 20 bar

Equipped with:

- Synthetic black rubber hoses R6
- Galvanized connections
- Swivelling joint 90° nickel-plated brass
- Viton seals



CFX-500	Article	Hose length	Ø hose	Inlet-outlet
	074-5502-300	Without hose	-	F3/8"G - M3/8"G
	074-5502-400	Without hose	-	M1/2"G - M1/2"G
	074-5502-212	12 m	5/16"	F3/8"G - M1/4"G
	074-5502-218	18 m	5/16"	F3/8"G - M1/4"G
	074-5502-310	10 m	3/8"	F3/8"G - M3/8"G
	074-5502-318	18 m	3/8"	F3/8"G - M3/8"G
	074-5502-410	10 m	1/2"	M1/2"G - M1/2"G
	074-5502-415	15 m	1/2"	M1/2"G - M1/2"G
	074-5502-418	18 m	1/2"	M1/2"G - M1/2"G

FOR WATER 150° C 200 bar

Equipped with:

- Synthetic rubber hoses no trace blue 1SC
- Galvanized connections
- Swivelling joint 90° stainless steel AISI 304
- Viton seals



CFX-500	Article	Hose length	Ø hose	Inlet-outlet
	074-5505-300	Without hose	-	M3/8"G - M3/8"G
	074-5504-210	10 m	5/16"	M3/8"G - M3/8"G
	074-5504-215	15 m	5/16"	M3/8"G - M3/8"G
	074-5504-310	10 m	3/8"	M3/8"G - F3/8"G
	074-5504-315	15 m	3/8"	M3/8"G - F3/8"G
	074-5504-318	18 m	3/8"	M3/8"G - F3/8"G

FOR WATER 150° C 400 bar

Equipped with:

- Synthetic rubber hoses no trace blue 2SC
- Galvanized connections
- Swivelling joint 90° stainless steel AISI 304
- Viton seals



CFX-500	Article	Hose length	Ø hose	Inlet-outlet
	074-5505-300	Without hose	-	M3/8"G - M3/8"G
	074-5505-310	10 m	3/8"	M3/8"G - F3/8"G
	074-5505-315	15 m	3/8"	M3/8"G - F3/8"G
	074-5505-318	18 m	3/8"	M3/8"G - F3/8"G

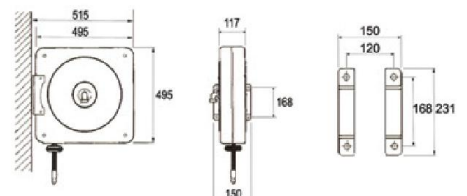

CFX-500 22,900x29,850 0,060 1



FOR AIR WATER 20 bar

Equipped with:

- Synthetic black rubber hoses R6
- Galvanized connections
- Swivelling joint 90° nickel-plated brass
- Viton seals

Article	Hose length	Ø hose	Inlet-outlet	CSX-500
075-5502-300	Without hose	-	F3/8" G - M3/8" G	
075-5502-400	Without hose	-	M1/2" G - M1/2" G	
075-5502-212	12 m	5/16"	F3/8" G - M1/4" G	
075-5502-218	18 m	5/16"	F3/8" G - M1/4" G	
075-5502-310	10 m	3/8"	F3/8" G - M3/8" G	
075-5502-318	18 m	3/8"	F3/8" G - M3/8" G	
075-5502-410	10 m	1/2"	M1/2" G - M1/2" G	
075-5502-415	15 m	1/2"	M1/2" G - M1/2" G	
075-5502-418	18 m	1/2"	M1/2" G - M1/2" G	



FOR WATER 150° C 200 bar

Equipped with:

- Synthetic rubber hoses no trace blue 1SC
- Galvanized connections
- Swivelling joint 90° stainless steel AISI 304
- Viton seals

Article	Hose length	Ø hose	Inlet-outlet	CSX-500
075-5505-300	Without hose	-	M3/8" G - M3/8" G	
075-5504-210	10 m	5/16"	M3/8" G - M3/8" G	
075-5504-215	15 m	5/16"	M3/8" G - M3/8" G	
075-5504-310	10 m	3/8"	M3/8" G - F3/8" G	
075-5504-315	15 m	3/8"	M3/8" G - F3/8" G	
075-5504-318	18 m	3/8"	M3/8" G - F3/8" G	



FOR WATER 150° C 400 bar

Equipped with:

- Synthetic rubber hoses no trace blue 2SC
- Galvanized connections
- Swivelling joint 90° stainless steel AISI 304
- Viton seals

Article	Hose length	Ø hose	Inlet-outlet	CSX-500
075-5505-300	Without hose	-	M3/8" G - M3/8" G	
075-5505-310	10 m	3/8"	M3/8" G - F3/8" G	
075-5505-315	15 m	3/8"	M3/8" G - F3/8" G	
075-5505-318	18 m	3/8"	M3/8" G - F3/8" G	

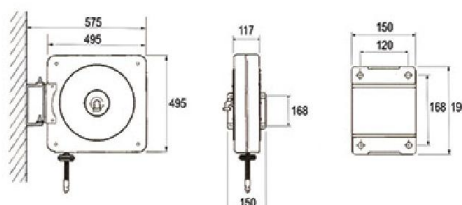

CSX-500 23,600<30,550 0,060 1